

rotary evaporator
RS 100 PRO
RS Lab



Rotary evaporator RS 100-PRO

model RS 100-PRO

We present the new rotary evaporator RSLAB model RS 100-PRO which expands our product line of evaporators. It includes some innovation : designed a detachable operating panel allows remote control with large LCD display for a digital control of lot of parameters as speed, temperature, timer.

Its range of applications is very large and provides reactions of distillation and separation liquid / liquid, liquid / solid, etc. This model can be used in many fields such as chemistry and biochemistry, food, industrial processes, research and education.



Rotary evaporator RS 100-PRO



features

- [01]** Wide LCD display provides together informations of speed, temperature and operation time
- [02]** Speed range from 20 up to 280 r.p.m.
- [03]** Large 5L water-oil heating bath with heating temperature range of RT to 180°C
- [04]** Digital temperature control and adjustable safety circuit
- [05]** Designed a detachable operating panel allows remote control
- [06]** Patented condenser(cooling surface 1,500 cm²) with excellent cooling effect
- [07]** Motorized lift with quick-action, automatic release evaporating flask to top position in case of power failure
- [08]** Adjustable final position recognition to protect operator and sample against breakage
- [09]** Evaporating flask with an ejector, convenient to remove
- [10]** Chemical-resistant double PTFE system and patented pressure spring provide excellent sealing
- [11]** PC can control and document all parameters via USB

Rotary evaporator RS 100-PRO

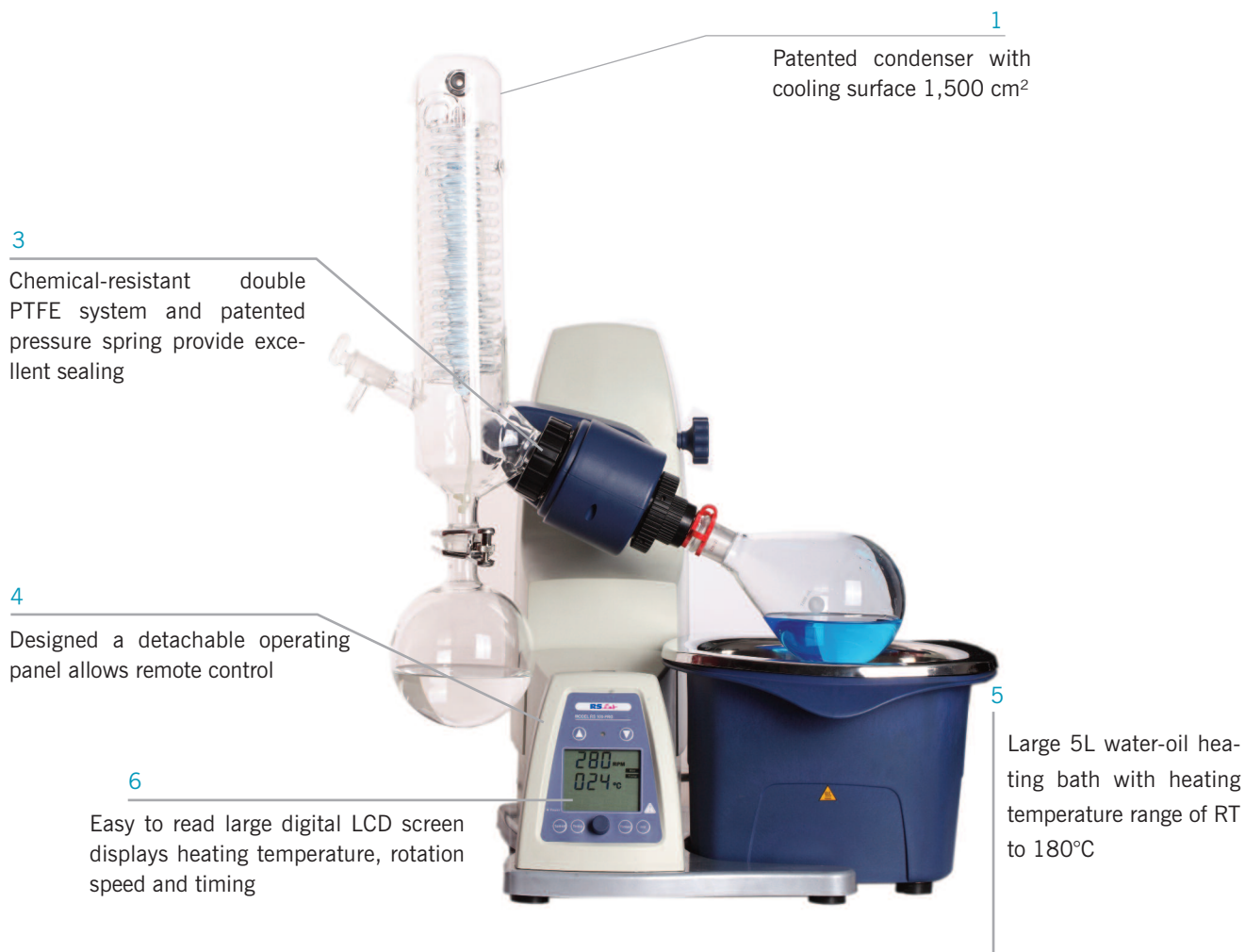

display



Rotary evaporator RS 100-PRO

technical specifications



Code	59400330
Power [W]	1400
Motor	DC brushless motor
Speed range [r.p.m.]	20 - 280
Speed display	LCD
Reversible direction of rotation	Yes
Temperature [°C]	RT - 180
Heat control accuracy [°C]	+/- 1
Temperature display	LCD
Lift	Motorized
Stroke [mm]	150
Timer	Oui
Timer display	LCD
Time setting range [mn]	1 à 999
Dimensions [D x P x H mm]	465 x 457 x 583
Weight [Kg]	15
USB	Yes
Protection Class acc. DIN EN60529	IP20

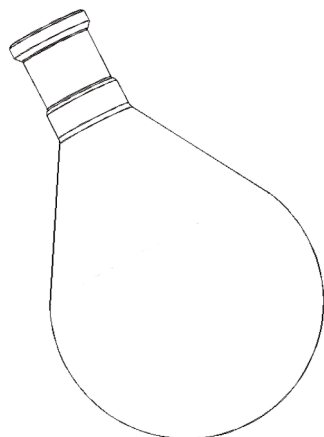

Evaporating flask 29/32

Code	Volume
76 920 201	50 mL
76 920 203	100 mL
76 920 205	250 mL
76 920 207	500 mL
76 920 209	1000 mL
76 920 210	2000 mL

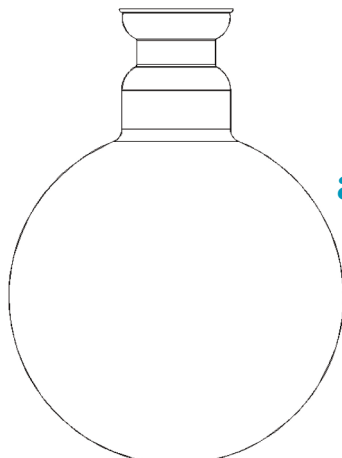

Receiving flask 35/20

Code	Volume
99410210	100 mL
99410220	250 mL
99410250	500 mL
99410310	1000 mL
99410320	2000 mL

Rotary evaporator RS 100-PRO

accessories / spare parts

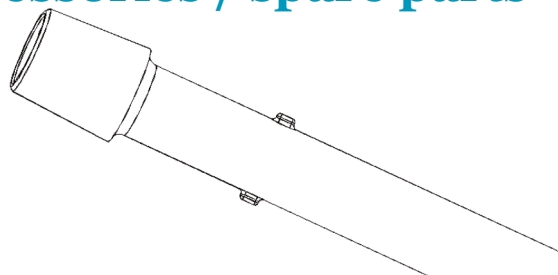

Vapor tube 29/32

Code	NS
99400014	29/32



Connector

Code	Rodage
99400010	NS 29/24
99400011	NS 29/19
99400012	NS 29/14



Spider with 5 flasks

Code	Volume
99400151	50 mL
99400211	100 mL



Foam brake 29/32

Code	Volume
99400013	250 mL



Seal

Code
99400015

Rotary evaporator RS 100-PRO

Accessory : vacuum pump



Code	45 910 009	45 910 110
Model	N-820	N-840
Vacuum pump rate to 1Atm	20L/min - 1,2m ³ /h	34L/min - 2,04m ³ /h
Vacuum limit absolute	8 mbar	8 mbar
Tube connection, Ø. interior	10 mm	10 mm
Number of head and phase	2	2
Head material	PTFE	PTFE
Membrane material	PTFE	PTFE
Valve material	FFPM	FFPM
Motor protection level	IP 44	IP 44
Dimensions [H x W x D cm]	21 x 15 x 31	23 x 17 x 34
Weight [Kg]	9,3	12,6

AUXILAB, S.L.
Polígono Morea Norte Calle D Nº 6
31191 Beriain - Navarra - España
T: +34 948 310 513
comercial@auxilab.es
www.auxilab.es

ROGO-SAMPAIC
23 Rue Ampère, ZI de Vilemilan
91325 Wissous - Paris - France
T: +33 1 69 53 67 67
rogosampaic@rogosampaic.com
www.rogosampaic.com



AUXILAB S.L.
Material de laboratorio
Laboratory supplies